



ROTAREX
FIRETEC



RISE-CERTIFIED ACCORDING TO
SPCR 183 / SP METHOD 4912



 **COMPACT LINE**
PRE ENGINEERED SYSTEMS FOR VEHICLE ENGINES

A COMPLETE DETECTION & SUPPRESSION SYSTEM PRE-ENGINEERED FOR VEHICLE ENGINES

- ★ Most compact system in the world¹
- ★ Able to protect up to 4m³ engine compartment with only 4 liters of agent¹
- ★ Protects passengers and valuable equipment
- ★ Easy / Flexible installation
- ★ Quick & Effective suppression
- ★ Highly Dependable: no electricity (FireDETEC tubing technology)
- ★ Improves productivity due to less maintenance, material change and downtime
- ★ A choice of suppression agents
- ★ A choice of detection systems

¹ According to UNECE R107 certification

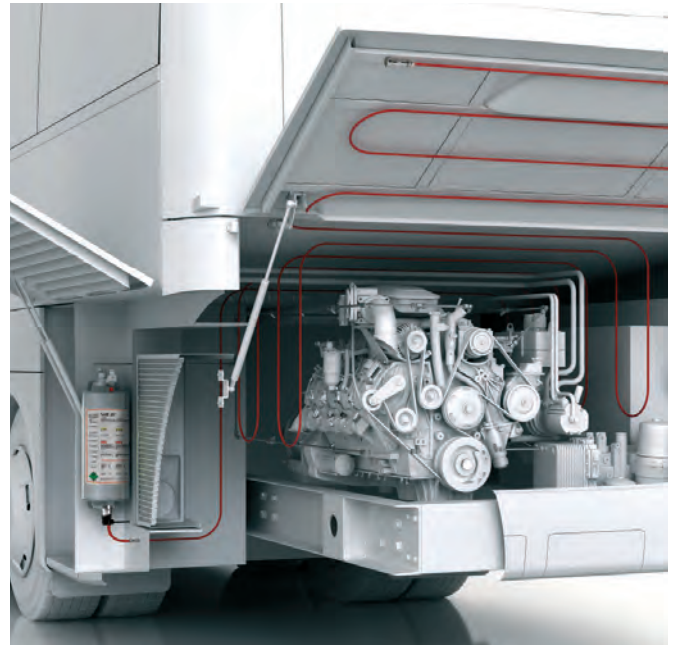

*Red tubing for visualization only. System is installed with black tubing.



FireDETEC Compact Line Vehicle Fire System was the first system to be RISE certified²

² P-MARK only applies to 7L size



An optional dashboard warning unit is available. It sends audible and visual signal in the event of a fire or system problem

COMPLETE READY-TO-INSTALL SYSTEMS SP OR UNECE APPROVED

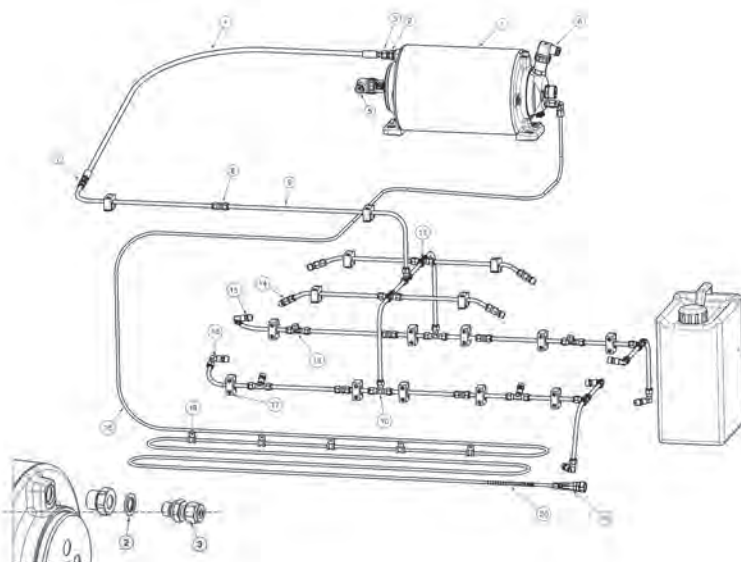

Pos.	Description
1	Special IHP cylinder/valve unit (unfilled)
2	Tube fitting
3	Flexible stainless steel hoses
4	Pressure switch (160 bar)
5	Pressure switch (5 bar)
6	Tube fitting - straight
7	Stainless steel pipe (1 meter)
8	Tube fitting - tee
9	Nozzle fitting - threaded elbow
10	Nozzle fitting - threaded tee
11	Spray nozzle
12	FireDETEC® tube (black, 10m)
13	Screw clip for tube attachment
14	End of line adapter
15	Protection spring for sensor tubing

PATENTED DUAL-CHAMBER CYLINDER TECHNOLOGY

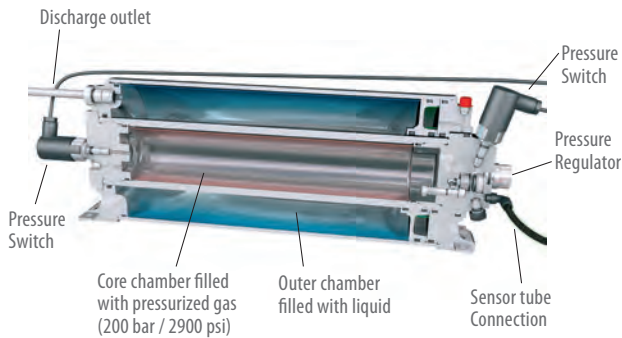

- Dual chamber = Safety
Extinguishing liquid and pressurized gas are in separate chambers
- When activated, the pressurized gas is released into the outer chamber forcing against a piston
- The piston pushes the liquid out through the discharge tube
- A built-in pressure regulator ensures a constant and sustained discharge

A cylinder for every need :



4L



7L



12L

A CHOICE OF AGENT

BERKICOLD*



- Biological foam concentrate
- Environmentally Friendly - Fluor Free
- Ideal for engine fires – rapidly removes heat and prevents reignition

FIREDETEC TS-55
COMPACT FIRE SUPPRESSION SYSTEMS



- Liquid-based agent (water mist) with glycol-free antifreeze
- Low freezing point
- Ideal for engine fires – rapidly removes heat and prevents reignition

A CHOICE OF DETECTION SYSTEMS

PNEUMATIC SENSOR TUBING



- 1. Quick & Easy installation directly inside engine compartments:**
The flexible sensor tubing is easily installed directly above and around the engine - closer to where a fire could start.

When in service, the tubing is pressurized with dry nitrogen to 16 bar. The dynamics of pressurization make the tubing more reactive to heat.

- 2. Early fire detection:**
If a fire occurs, the heat of the fire causes the pressurized sensor tube to burst at the hottest spot (approx. 110°C)
- 3. Instant suppression:**
The sudden tube depressurization actuates the special pressure differential valve and instantly floods the entire engine compartment extinguishing agent. The fire is quickly suppressed just moments after it began... minimizing damage and downtime.

ELECTRONIC DETECTION



- 1. Quick & Easy connection to existing electronic linear detection systems:**
Plug-&-Play connection to a solenoid actuator on the cylinder.

- 2. Instant suppression:**
The electronic detection system detects a fire and sends a signal to the solenoid valve which actuates the special pressure differential valve and instantly floods the entire engine compartment extinguishing agent. The fire is quickly suppressed just moments after it began... minimizing damage and downtime.

*Applies only to RISE Approval

WORLDWIDE HEADQUARTERS

24, rue de Diekirch,
L-7440 Lintgen
Luxembourg
Tel.: +352 32 78 32-1
Fax: +352 32 78 32-854
E-mail: firetec@rotarex.com

IDEAL FOR ALL VEHICLE ENGINE APPLICATIONS

